

DRAINAGE NOTES:
 ALL PROPOSED PUBLIC STORM WATER DRAINAGE WORKS TO BE IN ACCORDANCE WITH FINAG COUNTY COUNCIL'S REQUIREMENTS FOR PLANNING IN CHARGE AND IN ACCORDANCE WITH THE GREATER DUBLIN REGIONAL CODE OF PRACTICE FOR DRAINAGE WORKS.
 ALL PROPOSED PUBLIC TOLL WATER DRAINAGE WORKS TO BE IN ACCORDANCE WITH RISH WATER REQUIREMENTS.
 ALL PRIVATE DRAINAGE WORKS SHALL BE IN ACCORDANCE WITH THE BUILDING REGULATIONS AND RISH WATER REQUIREMENTS.
 ALL CANALS ARE TO BE IN ACCORDANCE WITH THE RISH WATER CODE OF PRACTICE FOR DRAINAGE WORKS. LEVELS IN REAR GARDENS HAVE BEEN ASSUMED AS STRAIGHT GRADE TO ADJACENT BOUNDARY FROM FFL - 150mm.
 EXTERNAL LEVELS TO BE CONFIRMED BY ARCHITECT.
GRANITY SEWER PIPE MATERIAL, TRENCH
 WASTEWATER PIPE MATERIALS SHALL BE IN ACCORDANCE WITH SECTION 3.13 OF THE RISH WATER CODE OF PRACTICE FOR WASTEWATER INFRASTRUCTURE.
 THE TRENCH AND FITTINGS OUTLINED HEREIN SHALL BE USED IN THE CONSTRUCTION OF THE GRANITY SEWER PIPE MATERIAL SHOULD NOT BE INSTALLED BY THE JOCKING OR MICRO TUNNELING.
CONCRETE: CONCRETE SEWER PIPES WITH SPOUT AND SOCKET JOINTS AND ROBBED RING FITTINGS SHALL COMPLY WITH IS 1916 (2002), BS 5911, PART 1 (2002 - 2010) AND IS 6 (2004) OR EQUIVALENT STANDARD, STRENGTH CLASS 120 WITH MINIMUM CRACKING LOADS IN ACCORDANCE WITH TABLE 8 OF BS 5911-1 (2002/2010).
 ALL PIPES AND FITTINGS SHALL HAVE GASKET THE JOINTS OF SPOUT AND SOCKET OR REBATED FORM (PIPE DIAMETERS 225MM AND ABOVE).
 THERMOPLASTIC STRUCTURED WALL PIPES, THERMOPLASTIC STRUCTURED WALL PIPES SHALL COMPLY WITH THE PROVISIONS OF IS EN 13476 (2007/2009), PIPES TO BE OF STRENGTH CLASS SKW/2 AND TO BE CAPABLE OF DEMONSTRATING A JETTING RESISTANCE OF 2,000 PSI (180 BAR) WITHOUT DAMAGE WHEN TESTED IN ACCORDANCE WITH SECTION 3.3 OF MS 1-35-01 (2008) (SEWER DIAMETERS 150MM UP TO 450MM, SERVICE CONNECTIONS OF 100MM DIAMETER).
 UNREINFORCED PVC PIPES AND FITTINGS SHALL COMPLY WITH THE PROVISIONS IS EN 1401 (2009/2012). PIPES TO BE APPLICATION AREA CODE 'UP', STRENGTH CLASS SKW/2. PROVISION FOR JETTING SHALL BE BASED ON THE WRC SEWER JETTING CODE OF PRACTICE, JUNE 1997. PIPES TO BE CAPABLE OF RESISTING A MAXIMUM JETTING PUMP PRESSURE OF 2,600PSI (180 BAR) WITHOUT DAMAGE. (SEWER DIAMETERS 150MM UP TO 450MM, SERVICE CONNECTIONS OF 100MM DIAMETER).
 OTHER: THE USE OF ALTERNATIVE PIPE TYPES AND MATERIALS WILL REQUIRE THE PRIOR WRITTEN AGREEMENT OF RISH WATER.
 WHERE 1.2m COVER TO ROLL WATER PIPE SLOPE IS NOT ACHIEVABLE IN PROVISIONS, SPOUT SUPPORT SHALL BE APPLIED IN ACCORDANCE WITH STD-WM-08 OF WASTEWATER INFRASTRUCTURE STANDARD DETAILS.
SERVICE LAYOUT DISTANCES:
 HORIZONTAL AND VERTICAL SERVICE LAYOUT DISTANCES SHALL BE AS PER RISH WATER STANDARD DETAIL STD-WM-05.
 THE EXTERNAL FACE OF MANHOLES SHALL BE AT LEAST 0.5m FROM KERB LINE.
RESTRICTIONS ON PLANNING:
 PLANNING ADJACENT TO WASTEWATER INFRASTRUCTURE SHALL BE IN COMPLIANCE WITH RISH WATER STANDARD DETAILS STD-WM-06 AND STD-WM-04A.

PRESENT DRAINAGE:
 ALL WASTEWATER FROM PRESENTS SHALL BE PUMPED TO GROUND LEVEL TO DISCHARGE BY GRANITY TO THE RISH WATER NETWORK IN ACCORDANCE WITH SECTION 3.25 OF THE RISH WATER CODE OF PRACTICE FOR WASTEWATER INFRASTRUCTURE. THE PUMPED WASTEWATER SHALL DISCHARGE INITIALLY TO A STANDOFF MANHOLE BEFORE DISCHARGING TO A GRANITY SEWER CONNECTION TO A MANHOLE ON THE PUBLIC SEWER.

Aug 18, 2019 - 3:31pm
 Drawing Location: \Map\Projects\81818-659 - Congriffin Planning Application\Drawings\Watermain Moylan\CD\Plan\SHD Application 21818-659\2000 Damage Layout.dwg

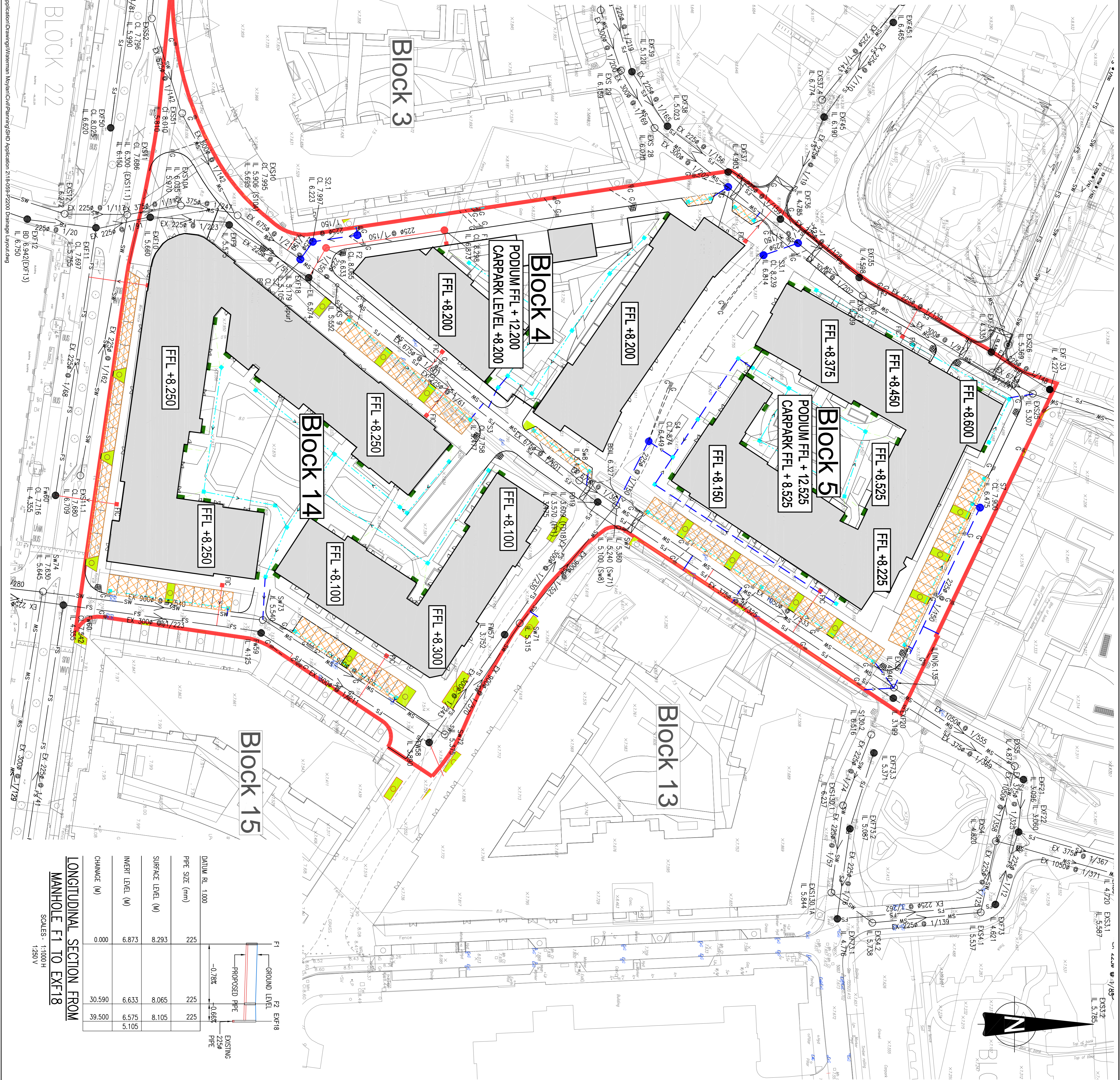

LONGITUDINAL SECTION FROM MANHOLE F1 TO EXF18
 SCALES - 1:1000 H, 1:250 V

PIPE SIZE (mm)	INVERT LEVEL (M)	CHANGING (M)
225	8.293	0.000
225	8.105	0.000
225	6.633	0.000
225	5.105	0.000

DATUM RL 1000
 PROPOSED PIPE: -0.75%
 EXISTING PIPE: -0.65%

Waterman Moylan
 Engineering Consultants
 BLOCK 5, EASTPOINT BUSINESS PARK, ALFIE BRYNE ROAD,
 DUBLIN D08 H9F4 IRELAND. TEL: 011 954 8800
 EMAIL: info@watermanmoylan.ie www.watermanmoylan.ie

GERARD GANNON PROPERTIES
 ARCHITECT CONROY CROWE KELLY

CONGRIFIN SHD APPLICATION 2

DRAWN	DESIGNED	APPROVED	DATE
PJD	PJD	MD	NOV 18'
SCALE	JOB NO.	PROJECT NO.	REVISION
1:500 @ A1	18-059	2200	A

FOR PLANNING NOT FOR CONSTRUCTION

Ordnance Survey Ireland Licence No. EN 0006019
 © Ordnance Survey Ireland/Government of Ireland.

REV.	DATE	AMENDMENT	DRN	APPD
A	12/06/19	REVISED FOR FINAL SUBMISSION	PJD	MD

LEGEND:
 - PROPOSED FOUL WATER SEWER WITH PIPE SIZE, GRADE, MANHOLE REF. AND INVERT LEVEL.
 - PROPOSED SURFACE WATER SEWER WITH PIPE SIZE, GRADE, MANHOLE REF. AND INVERT LEVEL.
 - PROPOSED PERFORATED SURFACE WATER PIPE WITH ACCESS JUNCTION / INSPECTION CHAMBER.
 - EX XXXX @ 1/XXX: EXX: FOUL WATER SEWER WITH PIPE SIZE, GRADE, MANHOLE REF. AND INVERT LEVEL; EXX: EXISTING SURFACE WATER SEWER WITH PIPE SIZE, GRADE, MANHOLE REF. AND INVERT LEVEL.
 - BO-RETENTION TREE PIT.
 - PERMEABLE PAVING.
 - PROPOSED GULLY AND CONNECTION.
 - EXISTING GULLY.

1:500 0 10.0 20.0 30.0 40.0 50.0m
 1:1 0 10 20 30 40 50 60 70 80 90 100

KEY PLAN
 SCALE: 1:10,000

NOTES:
 1. DO NOT SCALE. USE FIGURED DIMENSIONS ONLY.
 2. THIS DRAWING IS TO BE READ IN CONJUNCTION WITH ALL OTHER RELEVANT ARCHITECTURAL AND ENGINEERING DRAWINGS.
 3. IT IS THE CONTRACTOR'S RESPONSIBILITY TO ENSURE THAT ALL WORKS ARE CONSTRUCTED IN ACCORDANCE WITH THE RISH WATER CODE OF PRACTICE AND STANDARD DETAILS. THE CODE OF PRACTICE AND STANDARD DETAILS ARE AVAILABLE TO DOWNLOAD FROM THE RISH WATER WEB SITE AT WWW.WATER.EC.CONTRACTORS/DEVELOPER-SERVICES/ WHERE THE DETAILS OBTAINED ON THIS DRAWING DIFFER FROM THE RISH WATER CODE OF PRACTICE OR STANDARD DETAILS THIS MUST BE BROUGHT TO THE ATTENTION OF THE CLIENT IMMEDIATELY. RISH WATER STANDARDS WILL TAKE PRECEDENCE.

Aug 18, 2019 - 3:31pm
 Drawing Location: \Map\Projects\81818-659 - Congriffin Planning Application\Drawings\Watermain Moylan\CD\Plan\SHD Application 21818-659\2000 Damage Layout.dwg